

Flange Nyloc Insert Nut

Thread Type: Metric - Coarse

Thread Direction: Right Hand

Material: Carbon Steel

Class Grade: High Tensile Class 10

Finish: Zinc Yellow

Corrosion Protection Level: Moderate

Standard: DIN 6926

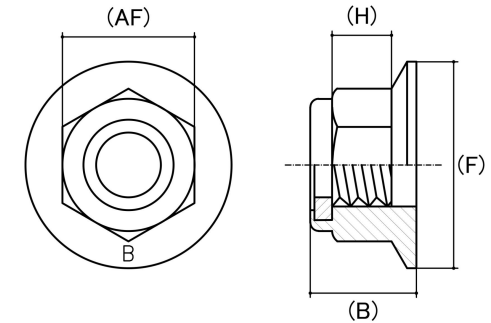

*CAD drawings shown for graphic representation only.**

Size	Thread Pitch (mm)	Thread Type	Overall Nut Height (B) (mm)		Hex Height (H) (mm)	Flange Diameter (F) (mm)	Across Flats (AF) (mm)		Spanner Size (AF) (mm)	sku (qfind)
			Min	Max	Nom	Nom	Min	Max		
M12	1.75	Coarse	15.67	16.00	8.55	25.00	17.73	18.00	18	41FLN12ZY
M14	2.00	Coarse	17.68	18.20	9.35	29.00	20.67	21.00	21	41FLN14ZY
M16	2.00	Coarse	19.46	20.00	11.30	34.00	23.67	24.00	24	41FLN16ZY
M20	2.50	Coarse	24.00	24.80	12.60	42.00	29.16	30.00	30	41FLN20ZY
M24	3.00	Coarse	29.00	29.80	15.60	45.00	35.16	36.00	36	41FLN24ZY

Disclaimer:

Dimensional data and technical information was obtained from publically available sources and not acquired through standard agencies. It has been completed and compiled for reference purposes only; where discrepancies are found they are subject to change without notice. Bolt & Nut Australia makes no warranties or representations regarding the accuracy and validity of the compiled information and data. Contact the relevant standard authorities for accurate and detailed information.

* CAD drawings may not reflect diameter, thread length or overall length.

© Bolt & Nut Australia Pty Ltd. All rights reserved.

Version: 18 Mar 2024